



CHINABEST HOME APPLIANCE CO.,LTD

Add: No 2, Fuqing Yi road, Henglan Zhongshan, Guangdong, China

Tel: 0086-760-2212 1616, 2212 1666

Fax:0086-760-2212 1178, 2212 6631

Email: trade@chinabest.com.cn

www.chinabest.com.cn/ www.vatti-china.com



OHSMS18001; ISO9001; ISO14001

CHINABEST | **vatti**

CATALOGUE

| 2016 |

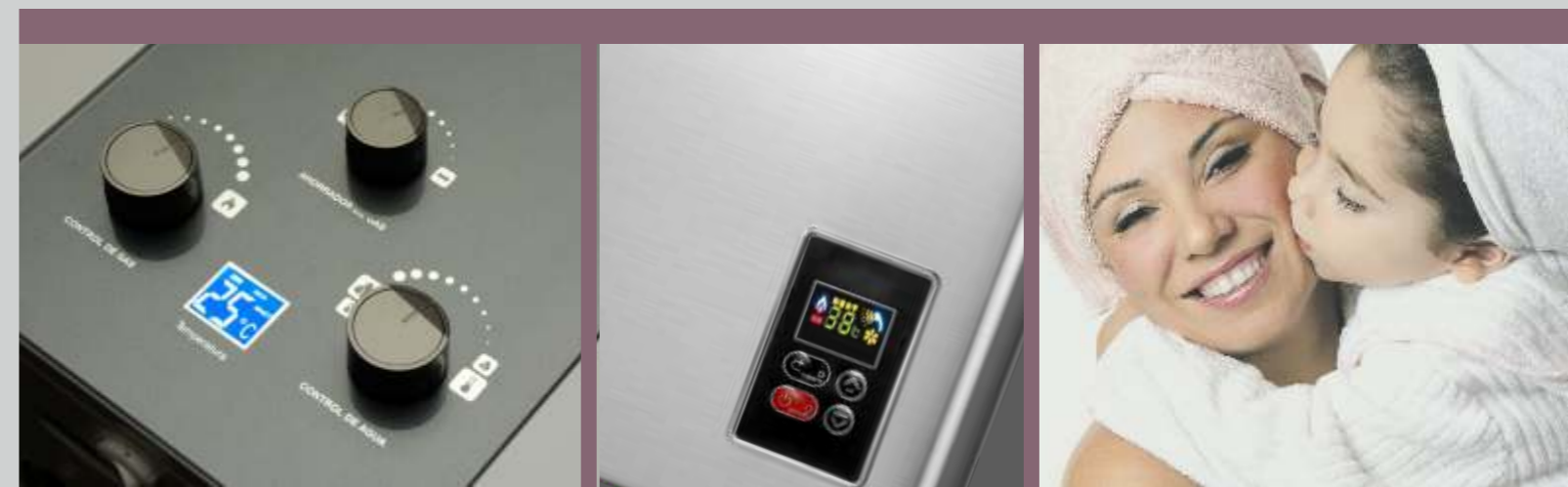

CHINABEST | **vatti**

Catalogue 2016

Brief Introduction

CHINABEST is located in Zhongshan, in the neighborhood of Guangzhou, Shenzhen, Shunde and Zhuhai, and it is also convenient to go to Hong Kong and Macao by ferry.

We are a leading professional manufacturer owning 25 years' experience in producing home appliances. 90 R&D engineers keep the innovations coming, creating 40 new product series annually, renewing designs and keeping the inventories of these multinationals fresh; and 66-member QC team performs a barrage of tests at every production phase to ensure you of first-rate products.

For cooker hoods, ovens, gas hobs and gas water heaters, including domestic and outdoor use, our manufacturing power and product selection are second to none. The daily capacity achieves over 6,000pcs for cooker hoods, 1000pcs for ovens, 15,000pcs for gas hobs, and 5,000pcs for gas water heaters.

We have over 200,000m² of floor space at our mainland China facilities. These facilities house 25 production lines and are manned by over 2,500 skilled workers. This enables us to turn out nearly 500,000 units monthly.

CHINABEST has won the certificate of ISO9001 and ISO14001, OHSMS18001, and most of products are with G.S, CE, CB, UL, ETL, AGA, SAI and ROHS approvals. Relying on the good quality and competitive price, the products have been exported to more than 70 countries and areas all over the world, and earned good reputation from the customers and markets.

We insist on growing along with our customers on the basis of mutual benefit and equality. If you want to know how we can cover your expectation, please contact us now!



Marketing Network

★ CHINABEST & VATTI

● COUNTRIES & AREAS WITH EXPORTED PRODUCTS





WATER HEATER

- Energy saving
- Double ignition pin, automatic electrical pulse ignition device
- Water-gas interlock valve device
- Winter-summer switch option for gas saving
- Flameout protection
- Over water pressure protection
- Anti-dry combustion protection
- Anti-freezing protection
- LCD available
- Hand shower available
- 20 minutes timer available
- Zero water pressure start for 5L&6L available
- Different colors available.



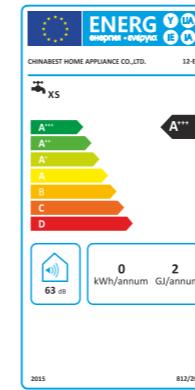
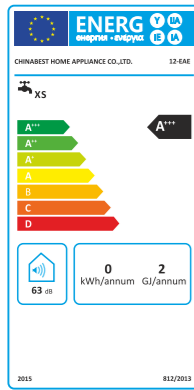

ECA/EAE SERIES

Duct exhaust type
CE for EAE Series

Model	Capacity	ErP Rating	Weight		Product Size & Meas		Container Loading Qty20'/40'/40HQ(pcs)
			N.W(kg)	G.W(kg)	Size(mm)	Meas(mm)	
10-EAE	5L	N/A	5.1	6.4	440x300x138	575x355x190	800/1600/1900
12-ECA/EAE	6L	A+++	5.1/5.2	6.4/6.5	440x300x138	575x355x190	800/1600/1900
14-EAE	7L	N/A	6.7	8.0	520x320x168	685x380x235	450/900/1070
16-ECA	8L	N/A	6.7	8.0	520x320x168	685x380x235	450/900/1070
20-ECA/EAE	10L	A	8.1/8.3	9.6/9.8	550x330x188	715x385x245	430/890/1050
24-ECA/EAE	12L	A	9.6/9.9	11.2/11.5	610x350x188	725x420x245	370/780/910
28-ECA/EAE	14L	B	10.6	12.2	650x400x188	780x460x240	320/660/770
32-ECA/EAE	16L	B	13/13.3	15.5/15.8	700x440x205	860x480x270	250/525/610

ECB/EBE SERIES

Duct exhaust type
CE for EBE Series

Model	Capacity	ErP Rating	Weight		Product Size & Meas		Container Loading Qty20'/40'/40HQ(pcs)
			N.W(kg)	G.W(kg)	Size(mm)	Meas(mm)	
10-EBE	5L	N/A	5.1	6.4	440x300x138	575x355x190	800/1600/1900
12-ECB/EBE	6L	A+++	5.1/5.2	6.4/6.5	440x300x138	575x355x190	800/1600/1900
14-EBE	7L	N/A	6.7	8.0	520x320x168	685x380x235	450/900/1070
16-ECB	8L	N/A	6.7	8.0	520x320x168	685x380x235	450/900/1070
20-ECB/EBE	10L	A	8.1/8.3	9.6/9.8	550x330x188	715x385x245	430/890/1050
24-ECB/EBE	12L	A	9.6/9.9	11.2/11.5	610x350x188	725x420x245	370/780/910
28-ECB/EBE	14L	B	10.6	12.2	650x400x188	780x460x240	320/660/770
32-ECB/EBE	16L	B	13/13.3	15.5/15.8	700x440x205	860x480x270	250/525/610

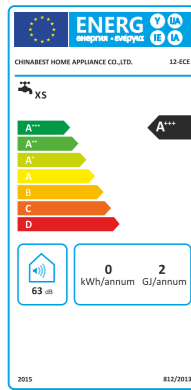

ECE/EC SERIES

Duct exhaust type
CE for ECE Series

Model	Capacity	ErP Rating	Weight		Product Size & Meas		Container Loading Qty20'/40'/40HQ(pcs)
			N.W(kg)	G.W(kg)	Size(mm)	Meas(mm)	
10-ECE	5L	N/A	5.1	6.4	440x300x138	575x355x190	800/1600/1900
12-ECE/EC	6L	A+++	5.1/5.2	6.4/6.5	440x300x138	575x355x190	800/1600/1900
14-ECE	7L	N/A	6.7	8.0	520x320x168	685x380x235	450/900/1070
16-EC	8L	N/A	6.7	8.0	520x320x168	685x380x235	450/900/1070
20-ECE/EC	10L	A	8.1/8.3	9.6/9.8	550x330x188	715x385x245	430/890/1050
24-ECE/EC	12L	A	9.6/9.9	11.2/11.5	610x350x188	725x420x245	370/780/910
28-ECE/EC	14L	B	10.6	12.2	650x400x188	780x460x240	320/660/770
32-ECE/EC	16L	B	13/13.3	15.5/15.8	700x440x205	860x480x270	250/525/610

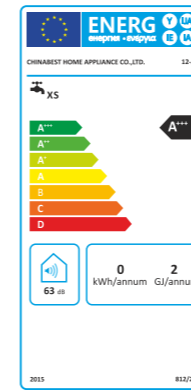

JE/J SERIES

Duct exhaust type
CE for JE Series

Model	Capacity	ErP Rating	Weight		Product Size & Meas		Container Loading Qty20'/40'/40HQ(pcs)
			N.W(kg)	G.W(kg)	Size(mm)	Meas(mm)	
10-JE	5L	N/A	5.1	6.4	440x300x138	575x355x190	800/1600/1900
12-JE/J	6L	A+++	5.1/5.2	6.4/6.5	440x300x138	575x355x190	800/1600/1900
14-JE	7L	N/A	6.7	8.0	520x320x168	685x380x235	450/900/1070
16-J	8L	N/A	6.7	8.0	520x320x168	685x380x235	450/900/1070
20-JE/J	10L	A	8.1/8.3	9.6/9.8	550x330x188	715x385x245	430/890/1050
24-JE/J	12L	A	9.6/9.9	11.2/11.5	610x350x188	725x420x245	370/780/910
28-JE/J	14L	B	10.6	12.2	650x400x188	780x460x240	320/660/770
32-JE/J	16L	B	13/13.3	15.5/15.8	700x440x205	860x480x270	250/525/610

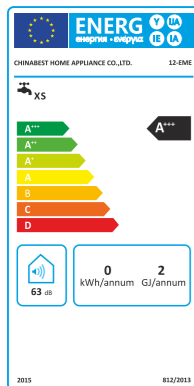

ECO series

CE

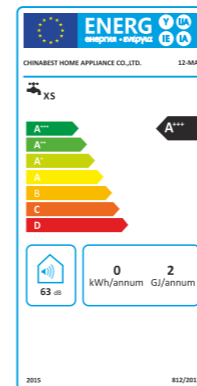

ECO series

CE



EME/EM SERIES

Duct exhaust type
CE for EME Series

Model	Capacity	ErP Rating	Weight		Product Size & Meas		Container Loading Qty20'/40'/40HQ(pcs)
			N.W(kg)	G.W(kg)	Size(mm)	Meas(mm)	
10-EME	5L	N/A	5.1	6.4	440x300x138	575x355x190	800/1600/1900
12-EME/EM	6L	A+++	5.1/5.2	6.4/6.5	440x300x138	575x355x190	800/1600/1900
14-EME	7L	N/A	6.7	8.0	520x320x168	685x380x235	450/900/1070
16-EM	8L	N/A	6.7	8.0	520x320x168	685x380x235	450/900/1070
20-EME/EM	10L	A	8.1/8.3	9.6/9.8	550x330x188	715x385x245	430/890/1050
24-EME/EM	12L	A	9.6/9.9	11.2/11.5	610x350x188	725x420x245	370/780/910
28-EME/EM	14L	B	10.6	12.2	650x400x188	780x460x240	320/660/770
32-EME/EM	16L	B	13/13.3	15.5/15.8	700x440x205	860x480x270	250/525/610

MAT/MA SERIES

Duct exhaust type
CE for MA Series

Model	Capacity	ErP Rating	Weight		Product Size & Meas		Container Loading Qty20'/40'/40HQ(pcs)
			N.W(kg)	G.W(kg)	Size(mm)	Meas(mm)	
10-MA	5L	N/A	5.1	6.4	440x300x138	575x355x190	800/1600/1900
12-MAT/MA	6L	A+++	5.1/5.2	6.4/6.5	440x300x138	575x355x190	800/1600/1900
14-MAT	7L	N/A	6.7	8.0	520x320x168	685x380x235	450/900/1070
16-MA	8L	N/A	6.7	8.0	520x320x168	685x380x235	450/900/1070
20-MAT/MA	10L	A	8.1/8.3	9.6/9.8	550x330x188	715x385x245	430/890/1050
24-MAT/MA	12L	A	9.6/9.9	11.2/11.5	610x350x188	725x420x245	370/780/910
28-MAT/MA	14L	B	10.6	12.2	650x400x188	780x460x240	320/660/770

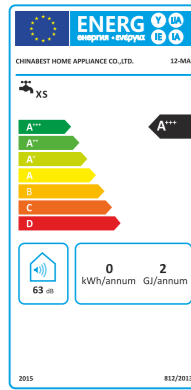

MAE SERIES

Duct exhaust type

Model	Capacity	ErP Rating	Weight		Product Size & Meas		Container Loading Qty20'/40'/40HQ(pcs)
			N.W(kg)	G.W(kg)	Size(mm)	Meas(mm)	
12MAE	6L	A+++	6.7	7.7	621x300x165	683x345x186	635/1300/1545
20MAE	10L	A	9.8	11	758x340x195	819x395x245	350/730/860

AC SERIES

Duct exhaust type

Model	Capacity	Weight		Product Size & Meas		Container Loading Qty20'/40'/40HQ(pcs)
		N.W(kg)	G.W(kg)	Size(mm)	Meas(mm)	
12-AC	6L	5.1	6.4	440x300x138	575x355x190	800/1600/1900
16-AC	8L	6.7	8	520x320x168	685x380x235	450/900/1070
20-AC	10L	8.1	9.6	550x330x188	715x385x245	430/890/1050
24-AC	12L	9.6	11.2	610x350x188	725x420x245	370/780/910
28-AC	14L	10.6	12.2	650x400x188	780x460x240	320/660/770



Force exhaust type



Duct exhaust type

EL SERIES

Duct exhaust type

Model	Capacity	Weight		Product Size & Meas		Container Loading Qty20'/40'/40HQ(pcs)
		N.W(kg)	G.W(kg)	Size(mm)	Meas(mm)	
D16EL	8L	8.1	9.6	550x330x188	715x385x245	430/890/1050
D20EL	10L	9.6	11.2	610x350x188	725x420x245	370/780/910
D24EL	12L	11.7	13	650x400x188	780x460x245	320/660/770

M SERIES

Model	Capacity	Weight		Product Size & Meas		Container Loading Qty20'/40'/40HQ(pcs)
		N.W(kg)	G.W(kg)	Size(mm)	Meas(mm)	
20-M	10L	9.5	10.9	600x345x175	710x400x240	430/870/1020
Q20-M	10L	12.0	14.5	600x345x175	710x475x240	360/740/810



LS SERIES

Duct exhaust type

Model	Capacity	Weight		Product Size & Meas		Container Loading Qty20'/40'/40HQ(pcs)
		N.W(kg)	G.W(kg)	Size(mm)	Meas(mm)	
10-LS	5L	4.7	5.8	432x290x120	555x345x175	885/1770/2100
12-LS	6L	5.4	6.8	472x272x130	615x315x220	660/1340/1595
14-LS	7L	6.2	7.8	502x302x145	630x360x220	570/1170/1370
16-LS	8L	8.5	10	520x320x175	650x385x240	480/975/1160
20-LS	10L	9.5	10.9	600x345x175	710x400x240	430/870/1020

L SERIES

Duct exhaust type

Model	Capacity	Weight		Product Size & Meas		Container Loading Qty20'/40'/40HQ(pcs)
		N.W(kg)	G.W(kg)	Size(mm)	Meas(mm)	
10-L	5L	4.7	5.8	432x290x120	555x345x175	885/1770/2100
12-L	6L	5.4	6.8	472x272x130	615x315x220	660/1340/1595
14-L	7L	6.2	7.8	502x302x145	630x360x220	570/1170/1370
16-L	8L	8.5	10	520x320x175	650x385x240	480/975/1160
20-L	10L	9.5	10.9	600x345x175	710x400x240	430/870/1020



Force exhaust type



Duct exhaust type



Force exhaust type



Duct exhaust type

G SERIES

Model	Capacity	Weight		Product Size & Meas		Container Loading Qty20'/40'/40HQ(pcs)
		N.W(kg)	G.W(kg)	Size(mm)	Meas(mm)	
20-G	10L	8.5	9.5	600x330x155	715x385x240	440/910/1060
24-G	12L	10.5	12	610x350x180	725x415x240	395/780/900
26-G	13L	12	14	650x400x185	780x460x235	340/690/815
Q20-G	10L	11	13	600x320x155	715x465x240	400/820/960
Q24-G	12L	12.3	15.0	610x350x180	725x490x240	335/680/800
Q26-G	13L	14.5	17.5	650x400x185	780x535x235	300/595/700

D SERIES

Model	Capacity	Weight		Product Size & Meas		Container Loading Qty20'/40'/40HQ(pcs)
		N.W(kg)	G.W(kg)	Size(mm)	Meas(mm)	
10-D	5L	4.7	5.8	432x290x120	555x345x175	885/1770/2100
12-D	6L	5.4	6.8	472x272x130	615x315x220	660/1340/1595
14-D	7L	6.2	7.8	502x302x145	630x360x220	570/1170/1370
16-D	8L	8.5	10	520x320x175	650x385x240	480/975/1160
20-D	10L	9.5	10.9	600x345x175	710x400x240	430/870/1020
32-D	16L	13.2	15.5	708x420x208	865x485x270	255/525/615
Q12-D	6L	8	10	472x272x130	620x390x220	550/1130/1310
Q14-D	7L	10	12	502x302x145	630x435x220	470/980/1150
Q16-D	8L	11.5	13.8	520x320x175	650x465x240	410/840/980
Q20-D	10L	12.0	14.5	600x345x175	710x475x240	360/740/860
Q32-D	16L	14.8	17.8	708x420x208	865x560x270	225/455/535



Force exhaust type



Duct exhaust type



Force exhaust type



Duct exhaust type

W SERIES

Model	Capacity	Weight		Product Size & Meas		Container Loading Qty20'/40'/40HQ(pcs)
		N.W(kg)	G.W(kg)	Size(mm)	Meas(mm)	
10-W	5L	4.7	5.8	432x290x120	555x345x175	885/1770/2100
12-W	6L	5.4	6.8	472x272x130	615x315x220	660/1340/1595
14-W	7L	6.2	7.8	502x302x145	630x360x220	570/1170/1370
16-W	8L	8.5	10	520x320x175	650x385x240	480/975/1160
20-W	10L	9.5	10.9	600x345x175	710x400x240	430/870/1020
32-W	16L	13.2	15.5	708x420x208	865x485x270	255/525/615
Q12-W	6L	8	10	472x272x130	620x390x220	550/1130/1310
Q14-W	7L	10	12	502x302x145	630x435x220	470/980/1150
Q16-W	8L	11.5	13.8	520x320x175	650x465x240	410/840/980
Q20-W	10L	12.0	14.5	600x345x175	710x475x240	360/740/860
Q32-W	16L	14.8	17.8	708x420x208	865x560x270	225/455/535

WG SERIES

Model	Capacity	Weight		Product Size & Meas		Container Loading Qty20'/40'/40HQ(pcs)
		N.W(kg)	G.W(kg)	Size(mm)	Meas(mm)	
10-WG	5L	4.9	6.0	432x290x120	555x345x175	885/1770/2100
12-WG	6L	5.6	7.0	472x272x130	615x315x220	660/1340/1595
16-WG	8L	8.8	10.3	520x320x175	650x385x240	480/975/1160
20-WG	10L	9.8	11.2	600x345x175	710x400x240	430/870/1020
24-WG	12L	10.8	12.3	610x350x180	725x415x240	395/780/900
32-WG	16L	13.5	15.8	708x420x208	865x485x270	255/525/615
Q12-WG	6L	8.2	10.2	472x272x130	620x390x220	550/1130/1310
Q16-WG	8L	11.7	14.0	520x320x175	650x465x240	410/840/980
Q20-WG	10L	12.2	14.7	600x345x175	710x475x240	360/740/860
Q24-WG	12L	12.6	15.3	610x350x180	725x490x240	335/680/800
Q32-WG	16L	15.2	18.2	708x420x208	865x560x270	225/455/535



EGE/EG SERIES

Duct exhaust type

Model	Capacity	Weight		Product Size & Meas		Container Loading Qty20'/40'/40HQ(pcs)
		N.W(kg)	G.W(kg)	Size(mm)	Meas(mm)	
20-EGE	10L	8.4	9.9	550x330x188	715x385x245	430/890/1050
20-EG	10L	8.2	9.7	550x330x188	715x385x245	430/890/1050

PERFECT
QUALITY CAN
BE TRUSTABLE



Force exhaust type



Duct exhaust type

F SERIES

Model	Capacity	Weight		Product Size & Meas		Container Loading Qty20'/40'/40HQ(pcs)
		N.W(kg)	G.W(kg)	Size(mm)	Meas(mm)	
10-F	5L	6.3	7.8	440x300x128	585x345x190	765/1350/1810
14-F	7	8.3	9.8	520x320x165	685x380x240	485/980/1140
16-F	8L	8.8	10.4	550x330x180	715x385x250	435/880/1045
20-F	10L	11	13	630x340x180	780x400x245	385/785/935
24-F	12L	10.5	12	610x350x180	725x415x240	395/780/900
32-F	16L	12	15.5	708x420x208	865x485x265	255/525/615
Q14-F	7L	9	10.5	520x320x165	680x455x235	395/800/950
Q16-F	8L	11.5	13.5	550x330x180	695x460x250	360/730/860
Q20-F	20L	12	14	630x340x180	770x470x240	315/640/755
Q24-F	24L	12.3	15	610x350x180	725x490x240	335/680/800
Q32-F	16L	14.5	17.5	650x400x185	865x560x270	300/595/700

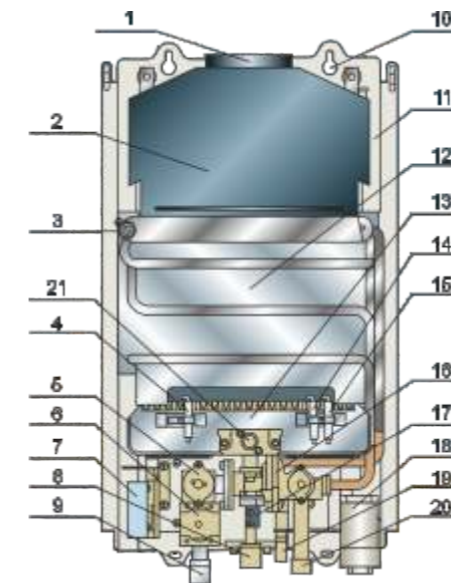

DUCT EXHAUST TYPE COMPONENTS

1. Exhaust tube
2. Exhaust gas collector
3. Temperature controller
4. Ignition pin I
5. Gas adjusting valve
6. Solenoid valve
7. Pulse generator
8. Hot water outlet
9. Gas inlet
10. Wall mounting holes
11. Back plate
12. Heat exchanger
13. Burner
14. Ignition pin II
15. Sensor pin
16. Water adjusting valve
17. Micro-active switch
18. Cell box
19. Release device
20. Water inlet
21. Winter/Summer switch

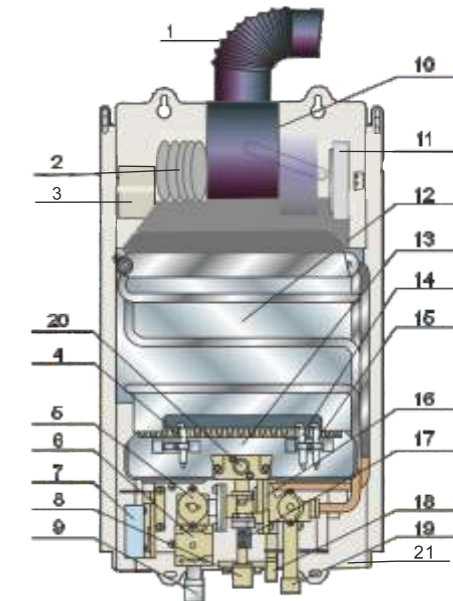

FORCE EXHAUST TYPE COMPONENTS

1. Exhaust pipe
2. Exhaust motor & fan
3. Capacitance
4. Ignition pin I
5. Gas adjusting valve
6. Solenoid valve
7. Pulse generator
8. Hot water outlet
9. Gas inlet
10. Exhaust gas collector
11. Air pressure switch
12. Heat exchanger
13. Burner
14. Ignition pin II
15. Sensor pin
16. Water adjusting valve
17. Micro-active switch
18. Release device
19. Water inlet
20. Winter/Summer switch
21. Back plate

CONSTANT
TEMPERATURE



TOUCH
CONTROL



DG SERIES

Duct Exhaust Type Constant Hot Water Heater

Components

- Constant hot water supply
- Only 1* 1.5V DC battery required
- Safer and explosive flame can be avoided as the pilot ignition adopted
- Low water pressure start up as the water flow sensor adopted

1. Exhaust tube
2. Exhaust gas collector
3. Back body
4. Heat exchanger
5. Temperature controller
6. Flame sensor pin
7. Pilot
8. Ignition pin
9. Burner
10. Hot water temperature sensor
11. Gas valve
12. Controller
13. Water flow sensor
14. Battery box
15. Water flow adjuster
16. Water outlet
17. Gas inlet
18. Water inlet
19. Release device

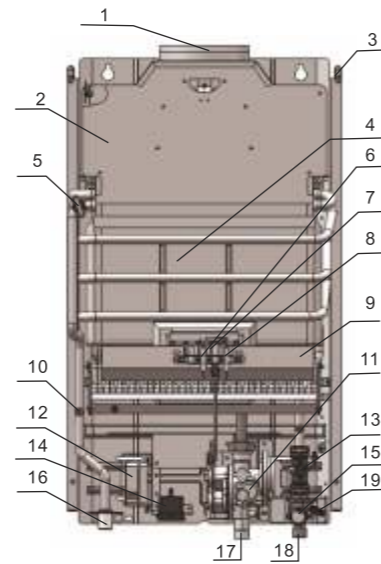

Model	Capacity	Weight		Product Size & Meas		Container Loading Qty20'/40'/40HQ(pcs)
		N.W(kg)	G.W(kg)	Size(mm)	Meas(mm)	
20-DG	10L	9.5	10.9	600x345x175	710x400x240	430/870/1020
32-DG	16L	13.2	15.5	708x420x208	865x485x270	255/525/615

DWG SERIES

Duct Exhaust Type Constant Hot Water Heater

Components

- Constant hot water supply
- Only 1* 1.5V DC battery required
- Safer and explosive flame can be avoided as the pilot ignition adopted
- Low water pressure start up as the water flow sensor adopted

- **Smart Touch Control**

1. Exhaust tube
2. Exhaust gas collector
3. Back body
4. Heat exchanger
5. Temperature controller
6. Flame sensor pin
7. Pilot
8. Ignition pin
9. Burner
10. Hot water temperature sensor
11. Gas valve
12. Controller
13. Water flow sensor
14. Battery box
15. Water flow adjuster
16. Water outlet
17. Gas inlet
18. Water inlet
19. Release device

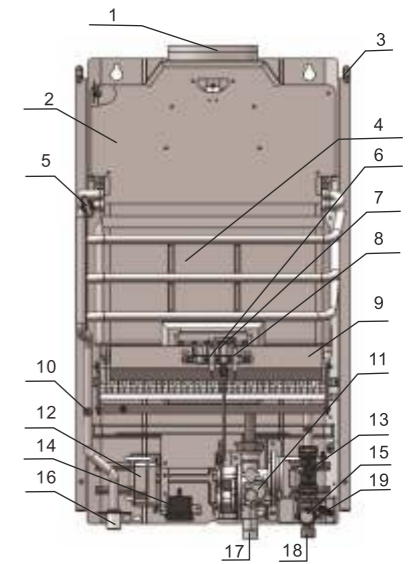

Model	Capacity	Weight		Product Size & Meas		Container Loading Qty20'/40'/40HQ(pcs)
		N.W(kg)	G.W(kg)	Size(mm)	Meas(mm)	
20-DWG	10L	9.8	11.2	600x345x175	710x400x240	430/870/1020
32-DWG	16L	13.5	15.8	708x420x208	865x485x270	255/525/615

OUTDOOR
PURPOSE
IS AVAILABLE



OUTDOOR
PURPOSE
IS AVAILABLE



11-VS
LCD available

11-V

11-VM

Components

1. Dust-proof lid
2. Thermocouple
3. Temperature controller
4. Sensor pin
5. Gas adjusting valve
6. Solenoid valve
7. Pulse generator
8. Gas inlet
9. Hot water outlet
10. Wall mounting holes
11. Back plate
12. Heat exchanger
13. Ignition pin I
14. Ignition pin II
15. Burner
16. Water adjusting valve
17. Micro-active switch
18. Cell box
19. Release device
20. Water inlet

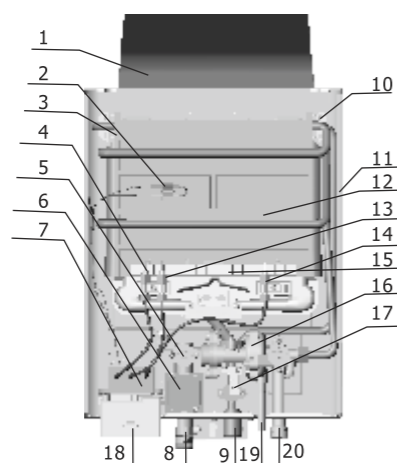

Components

1. Dust-proof lid
2. Thermocouple
3. Temperature controller
4. Sensor pin
5. Gas adjusting valve
6. Solenoid valve
7. Pulse generator
8. Gas inlet
9. Hot water outlet
10. Wall mounting holes
11. Back plate
12. Heat exchanger
13. Ignition pin I
14. Ignition pin II
15. Burner
16. Water adjusting valve
17. Micro-active switch
18. Cell box
19. Release device
20. Water inlet

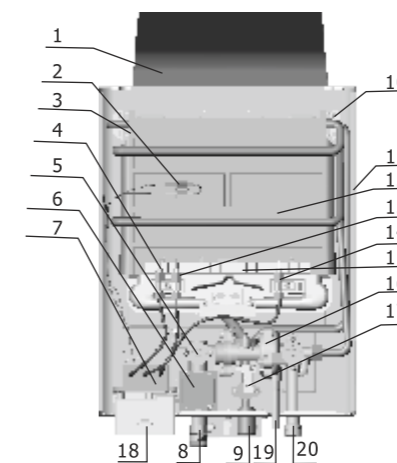

11-N

Natural exhaust type

Model	Capacity	Weight		Product Size & Meas		Container Loading Qty20'/40'/40HQ(pcs)
		N.W(kg)	G.W(kg)	Size(mm)	Meas(mm)	
11-N	5L	4.2	5.0	370x290x115	510x320x200	900/1750/2070

11-VS/11-V/11-VM

Natural exhaust type

Model	Capacity	Weight		Product Size & Meas		Container Loading Qty20'/40'/40HQ(pcs)
		N.W(kg)	G.W(kg)	Size(mm)	Meas(mm)	
11-VS	5L	4.3	6.8	400x295x130	555x320x195	680/1400/1620
11-V	5L	4.3	6.8	400x295x130	555x320x195	680/1400/1620
11-VM	5L	4.3	6.8	400x295x130	555x320x195	680/1400/1620



Q16M2/Q20M2

Force exhaust type

Model	Capacity	Weight		Product Size & Meas		Container Loading Qty20'/40'/40HQ(pcs)
		N.W(kg)	G.W(kg)	Size(mm)	Meas(mm)	
Q16M2	8L	10.2	11.3	500x320x120	650x375x205	560/1160/1360
Q20M2	10L	10.8	12.5	515x330x155	655x385x235	466/966/1130

Q40B2

Force exhaust type

Model	Capacity	Weight		Product Size & Meas		Container Loading Qty20'/40'/40HQ(pcs)
		N.W(kg)	G.W(kg)	Size(mm)	Meas(mm)	
Q40B2	20L	16.0	17.5	560x345x135	725x520x215	340/705/830



Q20-R



Q16-R



Ø60 Pipe available

Q16-R / Q20-R

Forced Draught Type

Constant hot water supply
Heat efficiency: over 88%

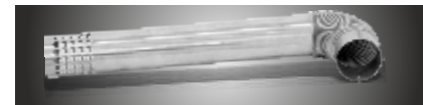

Ø50 Pipe available

Components

1. Exhaust pipe
2. Fan
3. Exhaust gas collector
4. Heat exchanger
5. Water temperature sensor
6. Burner
7. Electric wire
8. Water output
9. Gas input
10. Release valve
11. Water input
12. Water flow adjustment valve
13. Water flow transducer
14. Proportional valve
15. Ignition pin
16. Transformer
17. PC controller
18. Temperature controller
19. Air pressure switch
20. Capacitance

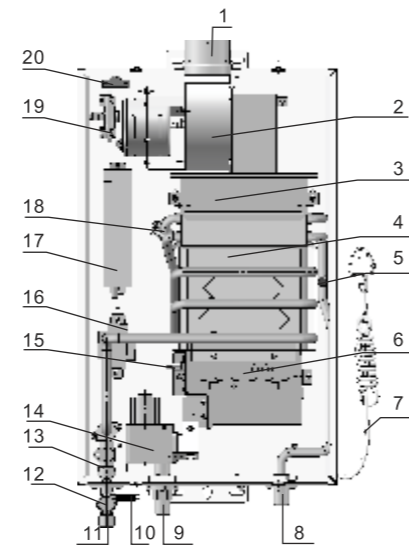

Model	Capacity	Power	Weight		Product Size & Meas		Pipe Dia. & Meas(mm) Ø50	Container Loading Qty20'/40'/40HQ(pcs)
			N.W(kg)	G.W(kg)	Size(mm)	Meas(mm)		
Q20-R	10L/m at Δt 25°C	20kW(68,200BTU)	11.5	12.8	560x350x142	710x420x230	600x197x68	370/750/880
Q16-R	8L/m at Δt 25°C	16kW(68,200BTU)	10	11.3	560x350x127	710x420x215	600x197x68	385/795/940

Q24-H2

Forced Draught Type

- Unique water-white lamination panel
- Advanced combustion technology, air-fuel ratio regulating and proportion regulating system
- Constant temperature control
- LED display and touch control
- Multiple safety devices, flame out, over water pressure, over heating, drying up, over wind pressure, flue blocking and anti-frozen, etc
- Thermal efficiency is over 88%
- Flue pipe diameter:φ100mm×φ60mm

Capacity	12L/m at Δt 25°C	
Power	24kW (81,000BTU)	
Weight	N.W(kg)	11
	G.W(kg)	12.3
Product Size & Meas	Size(mm)	560x350x142
	Meas(mm)	710x420x220
Pipe Dia. & Meas (mm)	Ø60	600x197x68
Container Loading	Qty20'/40'/40HQ (pcs)	425/ 1030 / 1152

Components

1. Exhaust pipe
2. Fan
3. Exhaust gas collector
4. Heat exchanger
5. Water temperature sensor
6. Burner
7. Electric wire
8. Water output
9. Gas input
10. Release valve
11. Water input
12. Water flow adjustment valve
13. Water flow transducer
14. Proportional valve
15. Ignition pin
16. Transformer
17. PC controller
18. Temperature controller
19. Air pressure switch
20. Capacitance

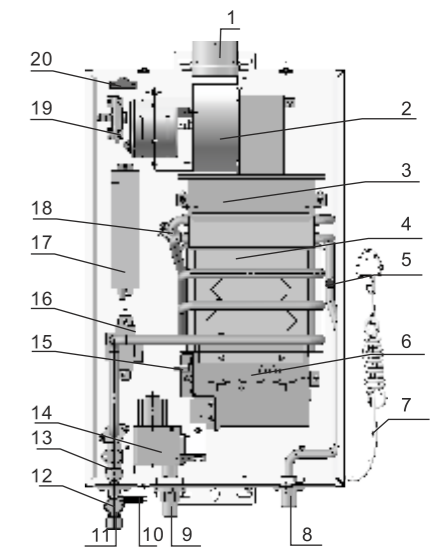



Q24-S2

Forced Draught Type

Constant hot water supply
Heat efficiency: over 88%



Ø80 Pipe available

Capacity	12L/m at Δt 25°C	
Power	24kW (81,000BTU)	
Weight	N.W(kg)	11.5
	G.W(kg)	13
Product Size & Meas	Size(mm)	560x350x106
	Meas(mm)	710x400x180
Pipe Dia. & Meas (mm)	Ø80	600x197x68
Container Loading	Qty20/40/40HQ (pcs)	470/ 965 / 1125

Components

1. Exhaust pipe
2. Air pressure switch
3. PC controller
4. Heat exchanger
5. Burner
6. Electric wire
7. Water flow transducer
8. Release valve
9. Water flow adjustment valve
10. Water input
11. Gas input
12. Water output
13. Fan
14. gas valve
15. Water temperature sensor
16. Temperature controller

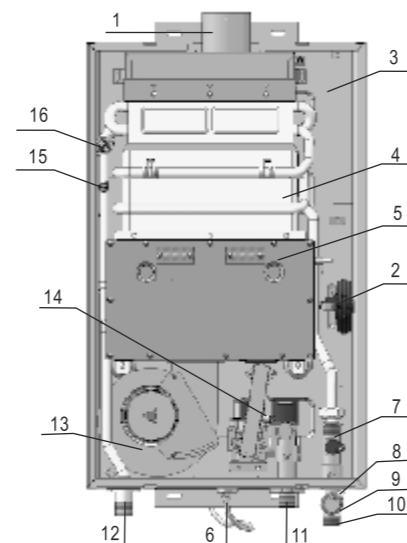

Q25-H

Forced Draught Type

Constant hot water supply
Heat efficiency: over 88%
Slim body



Ø60 Pipe available

Capacity	12L/m at Δt 25°C	
Power	25kW (81,300BTU)	
Weight	N.W(kg)	11.5
	G.W(kg)	13
Product Size & Meas	Size(mm)	560x350x106
	Meas(mm)	710x400x180
Pipe Dia. & Meas (mm)	Ø60	600x197x68
Container Loading	Qty20/40/40HQ (pcs)	470/ 965 / 1125

Components

1. Exhaust pipe
2. Air pressure switch
3. PC controller
4. Heat exchanger
5. Burner
6. Electric wire
7. Water flow transducer
8. Release valve
9. Water flow adjustment valve
10. Water input
11. Gas input
12. Water output
13. Fan
14. Proportional valve
15. Water temperature sensor
16. Temperature controller

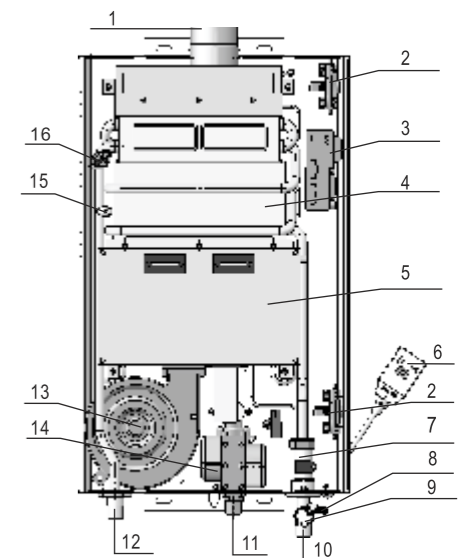



Q32-H1

Forced Draught Type

Constant hot water supply
Heat efficiency: over 88%

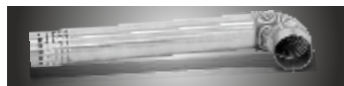

Ø60 Pipe available

Capacity	16L/m at Δt 25°C	
Power	32kW (110000BTU)	
Weight	N.W(kg)	12.8
	G.W(kg)	14.3
Product Size& Meas	Size(mm)	580x376x142
	Meas(mm)	710x442x213
Pipe Dia. & Meas (mm)	Ø60	600x197x68
Container Loading	Qty20/40/40HQ (pcs)	440 / 880 / 1000

Components

1. Capacitance
2. Air pressure switch
3. Back body
4. PC Controller
5. Plug
6. Transformer
7. Gas proportional valve
8. Gas input connector
9. Fan
10. Hot water temperature sensor
11. Heat exchanger
12. Burner
13. Hot water temperature sensor
14. Water proportional valve
15. Decorative plate

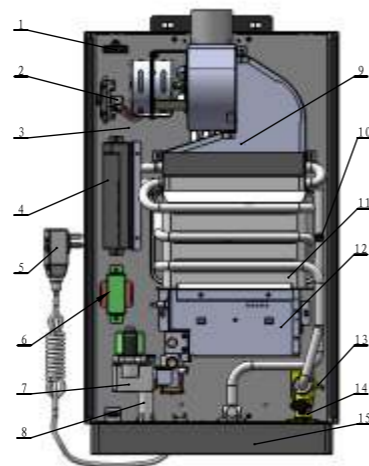

Q40-S2

Forced Draught Type

Constant hot water supply
Heat efficiency: over 88%



Ø60 Pipe available

Capacity	20L/m at Δt 25°C	
Power	40kW (81,3000BTU)	
Weight	N.W(kg)	17.2
	G.W(kg)	18.7
Product Size& Meas	Size(mm)	560x345x140
	Meas(mm)	730x425x215
Pipe Dia. & Meas (mm)	Ø80	630x175x88
Container Loading	Qty20/40/40HQ (pcs)	370 / 760 / 890

Components

1. Exhaust gas pipe
2. Exhaust gas collector
3. Heat exchanger
4. Ignition pin
5. Burner
6. Water temperature sensor I
7. Transformer
8. Proportional valve
9. Water flow transducer
10. Water flow adjustment valve
11. Water input
12. Gas input
13. Release device
14. Water output
15. Electric wire
16. PC controller
17. Fan
18. Water temperature sensor II
19. Temperature controller

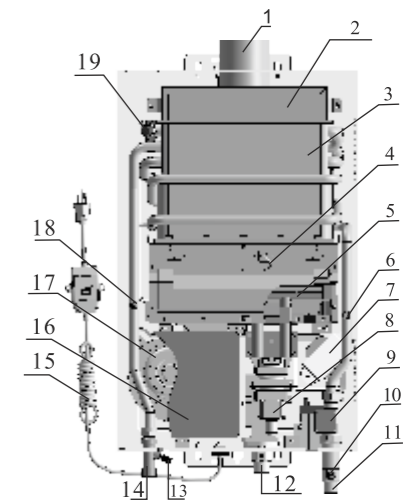



G16-R



G20-R

G20-R / G16-R

Balance Type

Constant hot water supply
Heat efficiency: over 88%



Ø60(inner);Ø90(outer) Pipe available

Components

1. Air input pipe base
2. Fan
3. Exhaust gas collector
4. Heat exchanger
5. Water temperature sensor
6. Burner
7. Electric wire
8. Water output
9. Gas input
10. Release valve
11. Water input
12. Water flow adjustment valve
13. Water flow transducer
14. Proportional valve
15. Ignition pin
16. Transformer
17. PC controller
18. Temperature controller
19. Air pressure switch
20. Capacitance
21. Exhaust pipe base

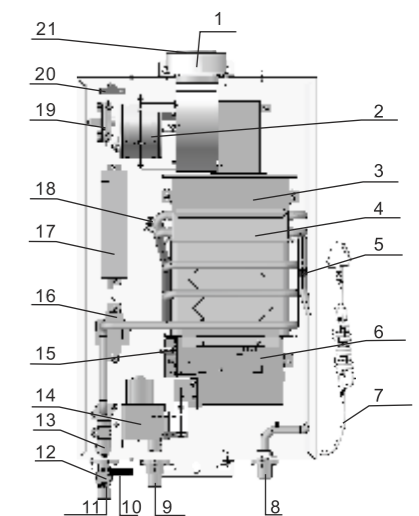

Model	Capacity	Power	Weight		Product Size & Meas		Pipe Dia. & Meas(mm)		Container Loading Qty20'/40'/40HQ(pcs)
			N.W(kg)	G.W(kg)	Size(mm)	Meas(mm)	Ø50(inner) Ø90(outer)	Ø60(inner) Ø90(outer)	
Q20-R	10L/m at Δt 25°C	20kW(68,200BTU)	11.7	13	560x350x142	710x420x230	740x195x120		370/750/880
Q16-R	8L/m at Δt 25°C	16kW(54,500BTU)	10.2	11.5	560x350x127	710x420x215	740x195x120		385/795/940



G24FW

Balance Type

Constant hot water supply
Heat efficiency: over 88%



Ø60(inner);Ø100(outer) Pipe available

Capacity	12L/m at Δt 25°C	
Power	24kW (81,800BTU)	
Weight	N.W(kg)	12.4
	G.W(kg)	14.0
Product Size & Meas	Size(mm)	621x350x174
	Meas(mm)	720x441x260
Container Loading	Qty20/40/40HQ (pcs)	365/ 883 / 990

Components

1. Ventilation base
2. Air pressure switch
3. Fan Assembly
4. Heat exchanger
5. Burner
6. Temperature sensor
7. Water outlet
8. Release valve
9. Hangle
10. Water valve
11. Knob
12. Gas inlet
13. Transformer
14. Temperature controller
15. Ignitor
16. Controller
17. Water flow sensor
18. Proportional valve
19. Water pipe assembly
20. Electricity wire

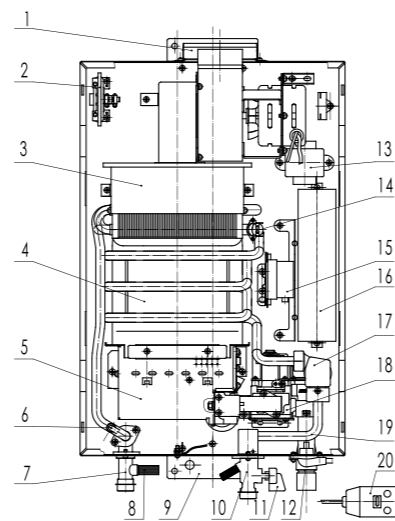

G24-S6

Balance Type

Constant hot water supply
Heat efficiency: over 88%
Slim body



Ø60(inner);Ø100(outer) Pipe available

Capacity	20L/m at Δt 25°C	
Power	24kW (81,800BTU)	
Weight	N.W(kg)	11.5
	G.W(kg)	13.0
Product Size & Meas	Size(mm)	560x350x106
	Meas(mm)	715x400x180
Pipe Dia. & Meas (mm)	Ø60(inner); Ø100(outer)	740x195x120
Container Loading	Qty20/40/40HQ (pcs)	405/ 830 / 970

Components

1. Air input pipe base
2. Air pressure switch
3. PC controller
4. Heat exchanger
5. Burner
6. Electric wire
7. Water flow transducer
8. Release valve
9. Water flow adjustment valve
10. Water input
11. Gas input
12. Water output
13. Proportional valve
14. Fan
15. Temperature controller
16. Exhaust gas pipe base
17. Water temperature sensor

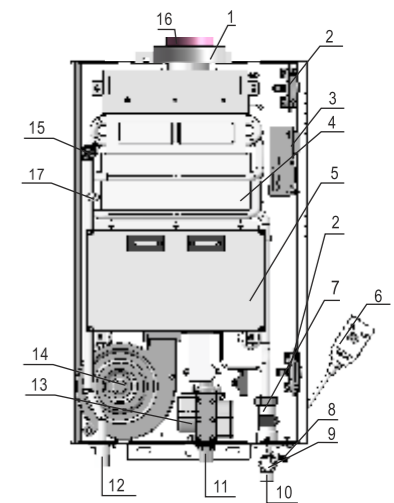



Ø80mm Adaptorx2



G25-H

Balance Type

Constant hot water supply
Heat efficiency: over 88%



Ø60(inner);Ø100(outer) Pipe available

Capacity	12L/m at Δt 25°C	
Power	25kW (81,300BTU)	
Weight	N.W(kg)	11.5
	G.W(kg)	13.0
Product Size & Meas	Size(mm)	560x350x106
	Meas(mm)	730x185x115
Pipe Dia. & Meas (mm)	Ø60;Ø60(inner);Ø100(outer)	740x510x200
Container Loading	Qty20/40/40HQ (pcs)	400 / 820 / 960

Components

1. Exhaust gas pipe base
2. Air pressure switch
3. PC controller
4. Heat exchanger
5. Burner
6. Electric wire
7. Water flow transducer
8. Release valve
9. Water flow adjustment valve
10. Water input
11. Gas input
12. Water output
13. Fan
14. Proportional valve
15. Water temperature sensor
16. Temperature controller

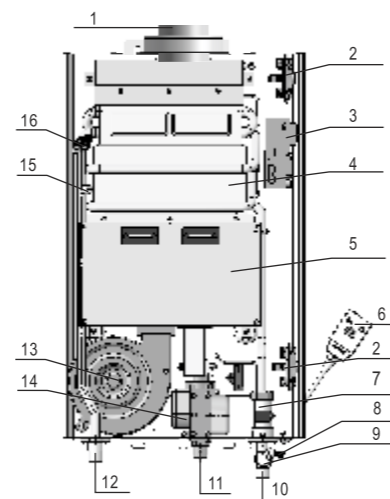

G32HWA

Balance Type

Constant hot water supply
Heat efficiency: over 88%



Capacity	16L(4.23gal)	
Power	32kW (110000BTU)	
Weight	N.W	16kg(35.27lbs)
	G.W	18.3kg(40.34lbs)
Product Size & Meas	Size	660x350x142mm (25.98x13.90x5.59inch)
	Meas	750x441x230mm (29.53x17.36x9.06inch)
Container Loading	Qty20/40/40HQ (pcs)	368 / 895 / 1000

Components

1. Ventilation base
2. Exhausted gas collector
3. Temp. controller
4. Heat exchanger
5. Sensor
6. Burner
7. DC fan
8. Ignitor
9. Transformer
10. Hot water temp. sensor
11. Cold water temp. sensor
12. Water outlet
13. Release valve
14. Water inlet
15. Water flow sensor
16. Hangle
17. Gas inlet
18. Fresh air inlet
19. PC controller
20. Ignition pin
21. Valve assembly
22. Air pressure switch
23. Gas proportional valve
24. Back body assembly
25. Electricity wire

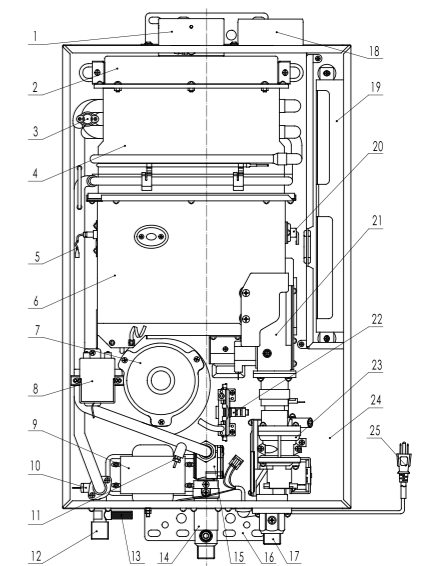



G40-S2

Balance Type

Constant hot water supply
Heat efficiency: over 88%



Ø80(inner);Ø120(outer) Pipe available

Capacity	20L/m at Δt 25°C	
Power	40kW (126,000BTU)	
Weight	N.W(kg)	17.2
	G.W(kg)	18.7
Product Size & Meas	Size(mm)	560x345x140
	Meas(mm)	715x425x215
Pipe Dia. & Meas (mm)	Ø80(inner); Ø120(outer)	800x235x128
Container Loading	Qty20/40/40HQ (pcs)	370/ 760 / 890

Components

1. Air input pipe base
2. Exhaust gas collector
3. Heat exchanger
4. Ignition pin
5. Burner
6. Water temperature sensor I
7. Transformer
8. Proportional valve
9. Water flow transducer
10. Water flow adjustment valve
11. Water input
12. Gas input
13. Release device
14. Water output
15. Electric wire
16. PC controller
17. Fan
18. Temperature controller
19. Exhaust gas pipe base
20. Water temperature sensor II

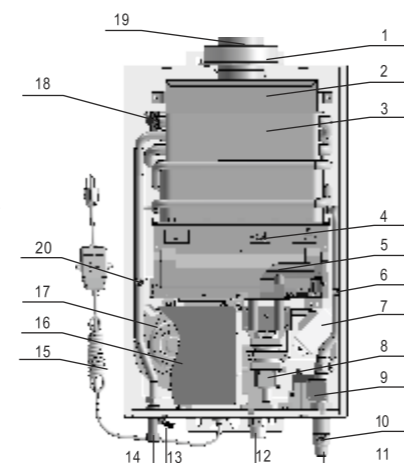

40-H

Outdoor Type

Constant hot water supply
Heat efficiency: over 88%

Capacity	20L/m at Δt 25°C	
Power	40kW (136,400BTU)	
Weight	N.W(kg)	15.6
	G.W(kg)	17.2
Product Size & Meas	Size(mm)	573x364x135
	Meas(mm)	735x425x215
Container Loading	Qty20/40/40HQ (pcs)	420/ 850 / 1000

Components

1. Exhaust gas ventilation hole
2. Heat exchanger
3. Ignition pin
4. Burner
5. Water temperature sensor I
6. Transformer
7. Proportional valve
8. Water flow transducer
9. Water flow adjustment valve
10. Water input
11. Gas input
12. Release device
13. Water output
14. Electric wire
15. PC controller
16. Fan
17. Water temperature sensor II
18. Temperature controller

